

### GENERAL NOTES

1. THE LANDSCAPING CHARACTER AREA FOR THE SITE IS: HAREWOOD.
2. REFER TO SITE PLAN PREPARED BY DE HOOG & KIERULF ARCHITECTS FOR SITE PLAN LAYOUT, PROPOSED FINISHED FLOOR ELEVATIONS AND OTHER ARCHITECTURAL INFORMATION.
3. REFER TO CIVIL PLANS AND REPORT PREPARED BY CASCARA CONSULTING ENGINEERS LTD. FOR ALL SITE SERVICING, GRADING AND DRAINAGE INFORMATION.
4. REFER TO TREE MANAGEMENT PLAN PREPARED BY TOTH AND ASSOCIATES ENVIRONMENTAL SERVICES FOR ALL TREE REMOVAL, RETENTION, REPLACEMENT AND PROTECTION INFORMATION. ALL OFF-SITE TREE RETENTION AND REMOVAL SHALL BE AS DIRECTED BY THE CITY OF NANAIMO.

### GRADING LEGEND

SYMBOL	DESCRIPTION
+ FFE 10.00	FINISHED FLOOR ELEVATION
+ FS 10.00	FINISHED SURFACE
+ FG 10.00	FINISHED GRADE
+ TW 10.00	TOP OF WALL
+ BW 10.00	BOTTOM OF WALL
+ TS 10.00	TOP OF STAIR
+ BS 10.00	BOTTOM OF STAIR
+ LP 10.00	LOW POINT
2% MIN. →	DRAINAGE DIRECTION AND SLOPE

### LAYOUT LEGEND

ABBREVIATIONS	DESCRIPTION
(E)	EXISTING
PL	PROPERTY LINE
PA	PLANTING AREA
TYP.	TYPICAL
SYMBOL	DESCRIPTION
---	PROPERTY LINE
□	2.0m TIMBER FENCE, REFER TO DETAIL ON SHEET L2
□	COLLIERY DAM FENCE, REFER TO DETAIL ON SHEET L2
▨	BROOM FINISH CONCRETE PAVING, STAIRS AND HANDRAIL
▨	1.2m GRAVEL PATH: 13mm (1/2") MINUS COMPACTED 'BLUE CHIP' AND TIMBER EDGE
▨	LEAVE STRIP: 0.45m WIDTH OF 50mm (2") MINUS, WASHED RIVER ROCK OVER LANDSCAPE FABRIC AND TIMBER EDGE
▨	RAIN GARDEN STONESCAPE: 200mm MINUS ROUND WASHED RIVER ROCK
▨	LANDSCAPE BOULDERS: 0.5m - 1.0m+ DIA. AT ROOF LEADER
▨	POST TOP ARBOR, REFER TO DETAIL ON SHEET L2
▨	FREESTANDING ARBOR AND GATE, REFER TO DETAIL ON SHEET L2
▨	BENCH, SURFACE MOUNTED ON BROOM FINISH CONCRETE PAD: QTY: 2 MANUFACTURER: WISHBONE SITE FURNISHINGS STYLE: AYLESBURY PARK BENCH BENCH REFER TO LAYOUT LEGEND DRAINAGE DEPRESSION REFER TO CIVIL PLANS
▨	PICNIC TABLE, SURFACE MOUNTED ON BROOM FINISH CONCRETE PAD: QTY: 1 MANUFACTURER: WISHBONE SITE FURNISHINGS STYLE: PARKER PICNIC TABLE MODEL: PKPT-6 SLAT COLOUR: HARBOUR GREY FRAME COLOUR: OIL RUB TEXTURED BRONZE
▨	LED BOLLARD LIGHTING: QTY: 15 MANUFACTURER: KING LUMINAIRE (OR EQUAL) STYLE: SILETTE MODEL: KL-A-5 COLOUR: BROWN METAL
▨	PARKING LOT LIGHTING (FULL CUT OFF, LED FLAT LENS): QTY: 3 MANUFACTURER: KING LUMINAIRE (OR EQUAL) STYLE: FALCONRIDGE LUMINAIRE WITH SINGLE ARM ON 5.2m (17') POLE MODEL: K203 WITH KA54-T1 ARM ON K5B97-RE POLE COLOUR: BROWN METAL
▨	FINAL PARKING LOT LIGHTING AND BOLLARD MAKES, MODELS, LOCATIONS, QUANTITIES AND PHOTOMETRIC ANALYSIS SHALL BE BY PROJECT ELECTRICAL ENGINEER.

### TREE PLANTING SUMMARY

LOCATION	LEVEL	LENGTH (m)	REQUIRED	PROPOSED
FRONT YARD:	1a - 6.0m	14	1	1
	1d - 1.8m	25	4	4
SIDE YARD (NORTH):	2a - 6.0m	25	2	2
	2d - 1.8m	30	5	5
SIDE YARD (SOUTH):	2a - 6.0m	10	1	2
	2c - 3.0m	12	1	3
REAR YARD:	2d - 1.8m	18	3	0
	2a - 6.0m	77	5	12
TOTAL			22	29

2. TREE REPLACEMENT SUMMARY:  
PER THE TREE REMOVAL APPLICATION PREPARED BY TOTH AND ASSOCIATES ENVIRONMENTAL SERVICES  
DOUGLAS FIR (*PSUEDOTSUGA MENZIESII*) 9  
BEAKED HAZELNUT (*CORYLUS CORNUTA*) 1  
TOTAL 10
3. THE TOTAL PROPOSED TREES OVER THE WHOLE SITE IS 29 TREES.

### IRRIGATION EQUIPMENT LEGEND

SYMBOL	MANUFACTURER	MODEL	DESCRIPTION
C	HUNTER	TBD	AUTOMATIC IRRIGATION CONTROLLER IN BUILDING A ELECTRICAL ROOM
ET	HUNTER	W55-5EN	WIRELESS SOLAR-SYNC SENSOR ON SOUTH-FACING EAVE
BF	BY MECHANICAL	BY MECHANICAL	38mm (1.5") DOUBLE CHECK BACKFLOW PREVENTER AND WATER SUPPLY IN ELECTRICAL ROOM.
---		SCHEDULE 40	38mm (1.5") PVC MAINLINE
---		SCHEDULE 40	PVC SLEEVES UNDER ALL PAVING AND THROUGH WALLS MIN. TYP. MAINLINE & CONTROL WIRE: 150mm (6") LATERALS: 100mm (4") BURIAL DEPTH TO MATCH DEPTH OF CARRIED PIPE.

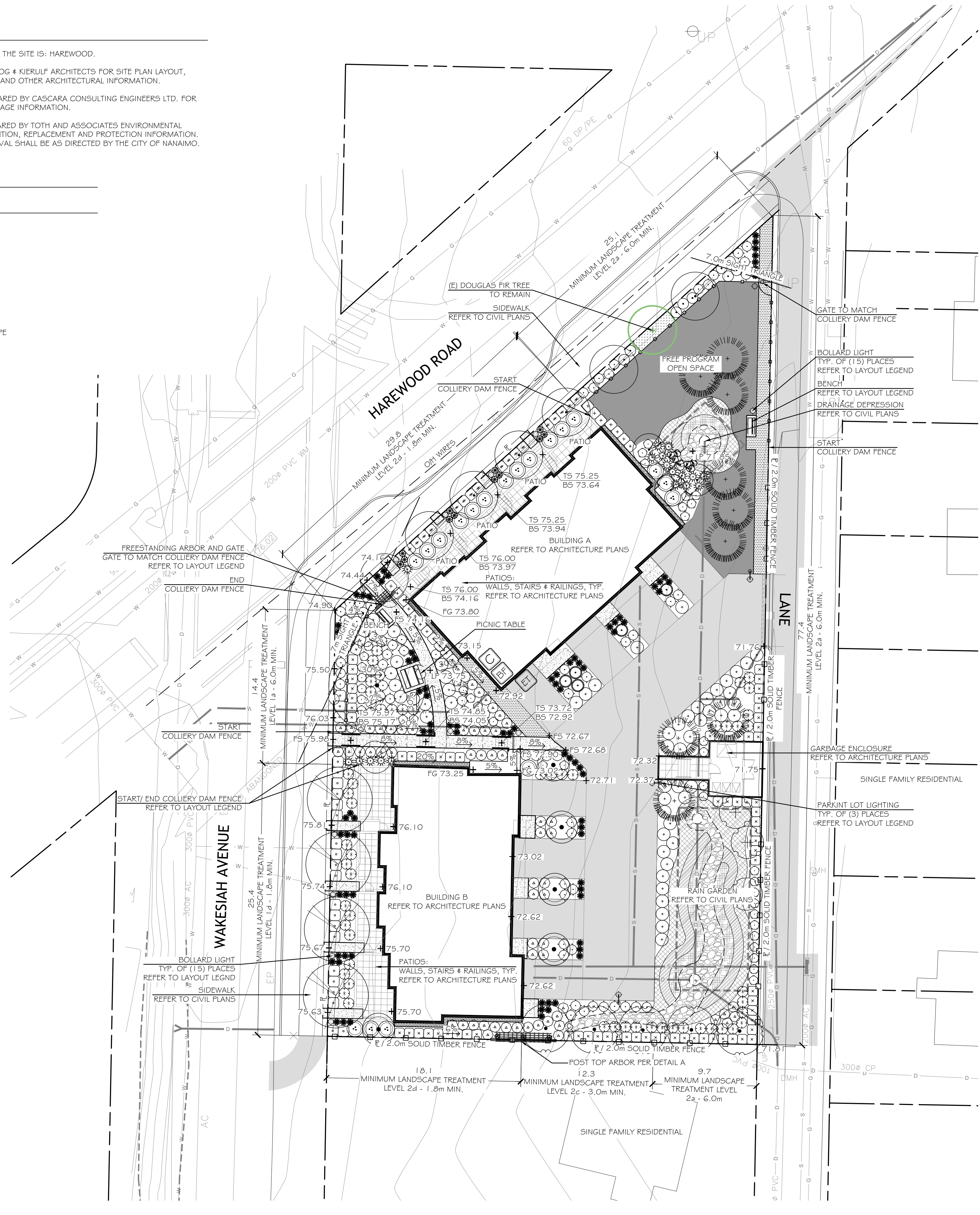

THIS DRAWING IS NOT FINAL AND SHALL NOT BE USED FOR CONSTRUCTION WORK UNTIL IT HAS BEEN STAMPED AND SIGNED BY THE LANDSCAPE ARCHITECT. THE COPYRIGHTS TO ALL DESIGNS AND DRAWINGS ARE THE PROPERTY OF MACDONALD GRAY CONSULTANTS. REPRODUCTION OR USE FOR ANY PURPOSE OTHER THAN THAT AUTHORIZED BY MACDONALD GRAY CONSULTANTS IS FORBIDDEN.

**Harewood Townhomes**  
**1360304 BC Ltd.**  
**610 Wakeshiah Avenue, Nanaimo, BC**

**LANDSCAPE ARCHITECTURE PLAN**  
 Date: November 29, 2023  
 Drawn: CM  
 Checked: CM  
 Scale: 1:200 metric  
 Project Number: 23-0349  
 DRAWING NUMBER: **L1 of 2**

REVISION SCHEDULE	NOTES
#	Date
0	08NOV2023 DP Review
1	29NOV2023 Issued for DP



COLLIERY DAM FENCE INSPIRATION

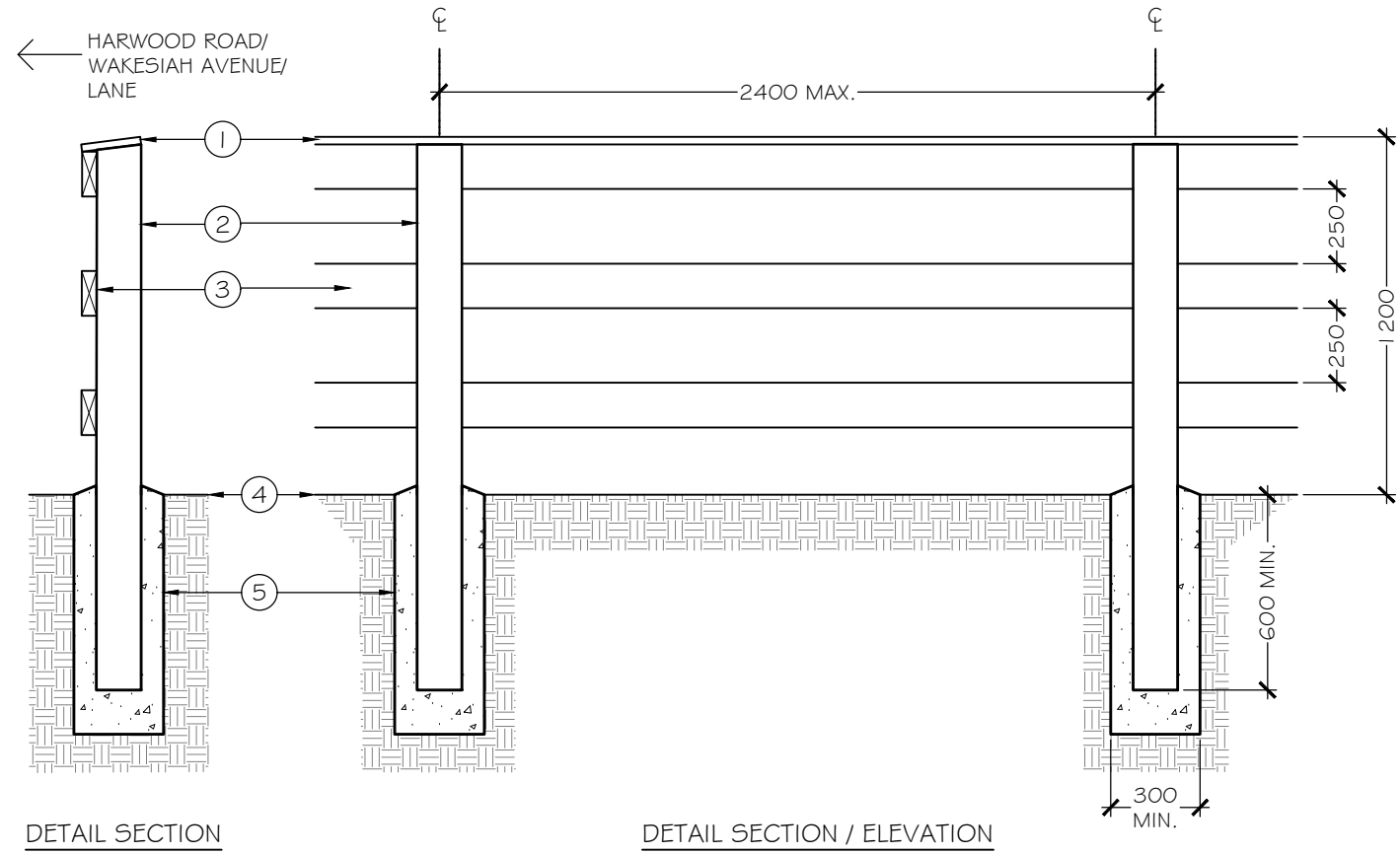

- ① 25mm X 200mm (1" X 8") CEDAR CAP RAIL
- ② 150mm X 150mm (6" X 6") CEDAR POST, TRIM TOP TO DRAIN
- ③ 50mm X 150mm (2" X 6") CEDAR RAIL, TYPICAL OF (3) PLACES, FASTEN WITH (2) GALVANIZED WOOD SCREWS PER POST-RAIL CONNECTION
- ④ FINISHED GRADE
- ⑤ CONCRETE FOOTING, SLOPE TO DRAIN

**A** Colliery Dam Fence  
Section/Elevation 1:25 metric

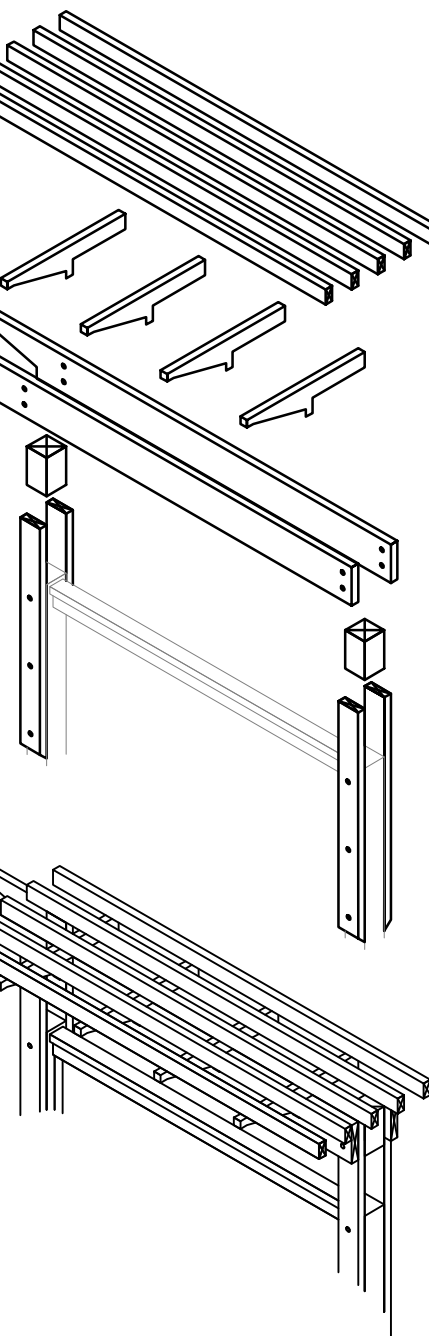

- ① 50mm X 150mm (2" X 6") CAP RAIL
- ② 150mm X 150mm (6" X 6") POST
- ③ 25mm X 100mm (1" X 4") SUB-RAIL, TYPICAL OF (3) PLACES
- ④ 50mm X 100mm (2" X 4") FENCE RAIL, TYPICAL OF (3) PLACES
- ⑤ 25mm X 150mm (1" X 6") FENCE BOARD, PLACED TIGHT
- ⑥ CONCRETE FOOTING, SLOPE TO DRAIN

FREE STANDING 4 POST TOP ARBOR SCHEMATIC NOT TO SCALE

**B** 2.0m Fence, Post Top & Freestanding Arbor  
Section/Elevation/Isometric 1:25 metric/As Noted

PLANTING NOTES

- ALL LANDSCAPE INSTALLATION AND MAINTENANCE SHALL MEET OR EXCEED THE MOST RECENT STANDARDS SET OUT BY THE CANADIAN LANDSCAPE NURSERY ASSOCIATION (CLNA) / CANADIAN SOCIETY OF LANDSCAPE ARCHITECTS (CSLA) CANADIAN LANDSCAPE STANDARD.
- ALL TREES SHALL BE PLANTED WITH 300mm OF TOPSOIL OR AMENDED ORGANIC SOILS AROUND AND BELOW ROOTBALL.
- SOIL DEPTHS: SHRUBS - 450mm  
GROUND COVER/ RAINGARDENS - 300mm  
LAWN - 100mm  
TREES - 300mm AROUND AND BELOW ROOTBALL
- MULCH SHALL BE COMPOST PER SECTION 10 MULCHING OF THE BCNTA/ BCSLA BC LANDSCAPE STANDARD. MULCH DEPTH SHALL BE 75mm MINIMUM OVER ALL TREE AND SHRUB PLANTING AREAS.
- PLANT MATERIAL QUALITY, TRANSPORT AND HANDLING SHALL COMPLY WITH BCNTA/ BCSLA STANDARDS FOR NURSERY STOCK.
- ALL PLANTING AREAS SHALL BE WATERED VIA AN UNDERGROUND AUTOMATIC IRRIGATION SYSTEM. IRRIGATION EMISSION DEVICES SHALL BE LOW VOLUME ROTARY NOZZLES OR MICRO/ DRIP EQUIPMENT.
- PLANT QUANTITIES ARE FOR INFORMATION ONLY. IN CASE OF ANY DISCREPANCY THE PLAN SHALL GOVERN.
- ALL PLANT MATERIAL SHALL MATCH SPECIES AS INDICATED ON THE PLANTING LEGEND.
- CONTACT THE LANDSCAPE ARCHITECT FOR APPROVAL OF ANY SUBSTITUTIONS. NO SUBSTITUTIONS WILL BE ACCEPTED WITHOUT PRIOR WRITTEN APPROVAL OF THE LANDSCAPE ARCHITECT.
- CHECK FOR LOCATIONS OF WATER LINES AND OTHER UNDERGROUND SERVICES PRIOR TO DIGGING TREE PITS. EXCAVATED PLANT PITS SHALL HAVE POSITIVE DRAINAGE. PLANT PITS WHEN FULLY FLOODED WITH WATER SHALL DRAIN WITHIN ONE HOUR AFTER FILLING.
- NO PLANTS REQUIRING PRUNING OF MAJOR BRANCHES DUE TO DISEASE, DAMAGE OR POOR FORM WILL BE ACCEPTED.
- ALL CALIFRE-STOCK TREES SHALL BE B # B IN WIRE BASKETS.

IRRIGATION NOTES

- IRRIGATION SYSTEM INSTALLATION SHALL MEET OR EXCEED THE THE REQUIREMENTS SET OUT IN THE MOST CURRENT VERSION OF THE CANADIAN NURSERY LANDSCAPE ASSOCIATION (CNLA) / CANADIAN SOCIETY OF LANDSCAPE ARCHITECTS (CSLA) CANADIAN LANDSCAPE STANDARD.
- IRRIGATION EMISSION DEVICES SHALL BE LOW VOLUME ROTARY NOZZLES OR MICRO/ DRIP EQUIPMENT.
- THE CONTRACTOR SHALL ADJUST THE PLACEMENT AND RADIUS OF SPRINKLERS AS REQUIRED BY FIELD CONDITIONS TO ACHIEVE FULL COVERAGE OF ALL PLANTED AREAS AND TO MINIMIZE OVER-SPRAY ONTO ADJACENT HARD SURFACES, FENCES AND PROPERTY LINES.
- ALL PIPING UNDER PAVING SHALL BE INSTALLED IN SEPARATE SCHEDULE 40 SLEEVES AT A MINIMUM DEPTH OF 600mm WITH 150mm OF SAND BACKFILL ABOVE AND BELOW PIPE. ALL WIRING UNDER PAVING SHALL BE INSTALLED IN SEPARATE SCHEDULE 40 PVC CONDUIT. ALL SLEEVES AND CONDUIT SHALL BE INSTALLED PRIOR TO PAVEMENT INSTALLATION AND SHALL EXTEND 150mm BEYOND EDGE OF PAVEMENT OR CURB. BACKFILL FOR SLEEVES SHALL BE COMPACTED TO THE SPECIFIED DENSITY FOR THE SUBGRADE.
- OPERATE IRRIGATION CONTROLLER WITHIN THE CITY OF NANAIMO WATER RESTRICTION SCHEDULE.

PLANT LEGEND

SYMBOL	BOTANICAL / COMMON NAME	SIZE	SPACING	QTY.	NOTES
<b>TREES</b>					
	CERCIS CANADENSIS 'FOREST PANSY' FOREST PANSY EASTERN REDBUD	6cm CAL.	6.0m O.C.	4	NATIVE CANADIAN CULTIVAR
	CORYLUS CORNUTA BEAKED HAZELNUT	1.5m	3.0m O.C. SEE PLAN	3	NATIVE SPECIES, (1) REPLACEMENT TREE
	FAGUS SYLVATICA 'DAWYCK GOLD' COLUMNAR GOLDEN BEECH	6cm CAL.	4.5m O.C.	5	DROUGHT TOLERANT
	GLEDITSIA TRIACANTHOS VAR. INERMIS SUNCOLE SUNBURST HONEY LOCUST	6cm CAL.	1.5m O.C.	1	DROUGHT TOLERANT
	MALUS 'GOLDEN RAINDROPS' GOLDEN RAINDROPS CRABAPPLE	6cm CAL.	6.0m O.C. SEE PLAN	7	NATIVE CULTIVAR, STREET TREE UNDER/ NEAR OVERHEAD WIRES
	PSEUDOTSUGA MENZIESII DOUGLAS FIR	2.5m	3.0m O.C. SEE PLAN	9	NATIVE SPECIES, REPLACEMENT TREES
<b>SHRUBS</b>					
	ACER CIRCINATUM VINE MAPLE	#5 POT	3.0m O.C. SEE PLAN	4	NATIVE SPECIES
	BERBERIS THUNBERGII 'CONCORDE' CONCORDE JAPANESE BARBERRY	#2 POT	1.0m O.C.	59	DROUGHT TOLERANT
	CHOISYA TERNATA MEXICAN ORANGE	#1 POT	1.0m O.C.	57	DROUGHT TOLERANT
	COTINUS COGGYGRIA 'ANGOT' GOLDEN SPIRIT SMOKE BUSH	#5 POT	SEE PLAN	5	DROUGHT TOLERANT
	ILEX CRENATA 'CONVEXA' JAPANESE HOLLY	#1 POT	1.0m O.C.	23	DROUGHT TOLERANT, LOW HEDGE
	JUNIPERUS SABINA 'TAMARISCIFOLIA' TAMARIX JUNIPER	#2 POT	1.0m O.C.	15	DROUGHT TOLERANT
	JUNIPERUS SCOPULORUM 'WICHITA BLUE' WICHITA BLUE JUNIPER	#5 POT	SEE PLAN	5	DROUGHT TOLERANT
	LONICERA NITIDA 'LEMON BEAUTY' LEMON BEAUTY BOX HONEYSUCKLE	#1 POT	1.2m O.C.	56	DROUGHT TOLERANT
	MAHONIA AQUIFOLIUM OREGON GRAPE	#2 POT	1.0m O.C.	44	NATIVE SPECIES, DROUGHT TOLERANT
	POLYSTICHUM MUNITUM SWORD FERN	#2 POT	1.0m O.C.	18	NATIVE SPECIES
	PRUNUS LAUROCERASUS 'OTTO LUYKEN' DWARF ENGLISH LAUREL	#2 POT	1.0m O.C.	17	DROUGHT TOLERANT, LOW HEDGE
	RHOODODENDRON SSP. MIX RED & WHITE	#5 POT	SEE PLAN	19	DROUGHT TOLERANT
	THUJA PLICATA 'EXCELSA' EXCELSA RED CEDAR	1.5m	0.9m O.C.	94	NATIVE CULTIVAR, 1.8m HEDGE
	VIBURNUM DAVIDII DAVID'S VIBURNUM	#1 POT	1.0m O.C.	65	DROUGHT TOLERANT
<b>GROUND COVER, VINES &amp; PERENNIALS</b>					
	CAREX OBNUPTA/ STIPITA SLOUGH/ SAWBEAK SEDGE	PLUG	0.6m O.C.	90	NATIVE SPECIES
	CLEMATIS ARMANDII EVERGREEN CLEMATIS	#1 POT	1 PER POST	3	VINE ON POST TOP ARBOR
	CORNUS SERICEA 'KELSEYII' KELSEY'S DWARF DOGWOOD	#1 POT	0.6m O.C.	180	NATIVE CULTIVAR
	HAKONECHLOA MACRA 'AUREOLA' GOLDEN JAPANESE FOREST GRASS	#2 POT	0.6m O.C.	12	SHADE TOLERANT
	JUNCUS EFFUSUS COMMON RUSH	PLUG	0.6m O.C.	95	NATIVE SPECIES
	MAHONIA NERVOOSA CASCADE OREGON GRAPE	10cm POT	0.45m O.C.	25	NATIVE SPECIES
	PENNISETUM ALOPECUROIDES 'HAMELI' DWARF FOUNTAIN GRASS	#2 POT	0.6m O.C.	89	DROUGHT TOLERANT
	LAWN; CANADA NO. 1	SOD		200m <sup>2</sup>	

NOTE: DROUGHT TOLERANCE IS BASED ON SPECIES ONCE ESTABLISHED



THIS DRAWING IS NOT FINAL AND SHALL NOT BE USED FOR CONSTRUCTION WORK UNTIL IT HAS BEEN STAMPED AND SIGNED BY THE LANDSCAPE ARCHITECT. THE COPYRIGHTS TO ALL DESIGNS AND DRAWINGS ARE THE PROPERTY OF MACDONALD GRAY CONSULTANTS. REPRODUCTION OR USE FOR ANY PURPOSE OTHER THAN THAT AUTHORIZED BY MACDONALD GRAY CONSULTANTS IS FORBIDDEN.

**Harewood Townhomes**  
1360304 BC Ltd.  
610 Wakesiah Avenue, Nanaimo, BC

**LEGENDS, NOTES & DETAILS**  
PLAN

Date: November 29, 2023  
Drawn: CM  
Checked: CM  
Scale: AS NOTED  
Project Number: 23-0349  
DRAWING NUMBER: **L2 of 2**

REVISION SCHEDULE		NOTES	
#	Date	By	Notes
0	08NOV2023	DP	Review
1	29NOV2023	Issued for DP	